

Material: Brass Compliant NSF 372
Working Temperature: -20 ÷ 150 C°
Working Temperature: F°
Working Pressure (max): 18 bar
Working Pressure (max): psi
Vacuum: -99 kPa
Vacuum: Hg
Conformity: NSF 169

Conformity: M.O.C.A.
Conformity: 1935/2004/EC
Conformity: 2023/2006/EC
Conformity: RoHS
Application Food and Beverage Applications

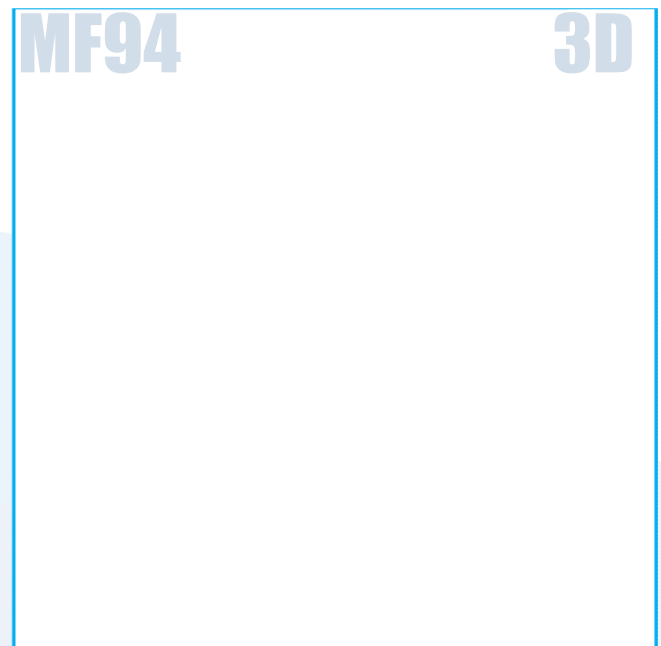
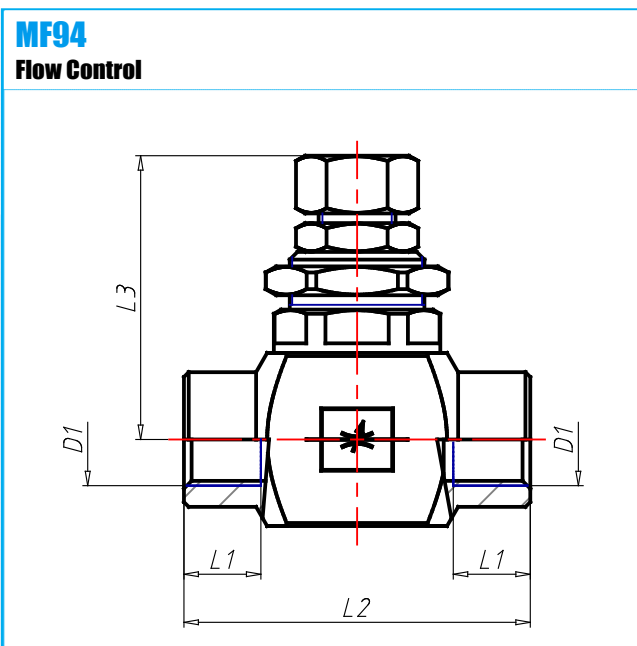

CODE	TIPO	TUBO	L1	L2	L3MAX	G	CONF4	CONF5
F0840B01	MF94 18 18	G1/8	8	36	32.5	76.1	2023/2006/EC	RoHS
F0840B02	MF94 14 14	G1/4	9	41	32.5	85.8	2023/2006/EC	RoHS