



Filtro-riduttore autoazionato con otturatore bilanciato. Il controllo della pressione in uscita è gestito da una membrana in gomma (F38-F12 MD) o un pistone (F15-F20MD). La filtrazione avviene per mezzo di una robusta cartuccia di materiale sinterizzato. Funzione **relieving** e funzione di **scarico della condensa**.

*Self-operated filter-regulator with balanced plug. Outlet pressure is controlled by a diaphragm (FR38-FR12 MD) or a piston (FR15-FR20 MD). Filter cartridge realized in strong sintered material.*

**Relieving function and condensate drain function.**

FR38-FR12 MD

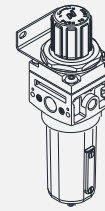
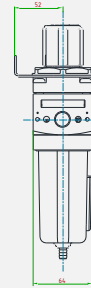
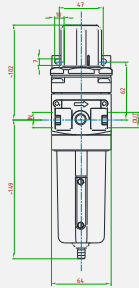

FR15-FR20 MD

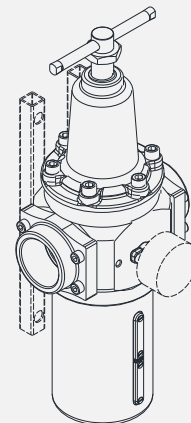
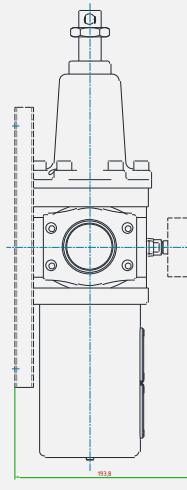
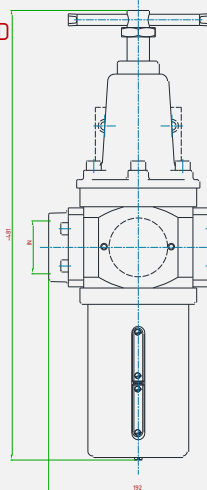

**CARATTERISTICHE PRINCIPALI**  
**MAIN FEATURES**

COMPATIBILITÀ COMPATIBILITY	Aria compressa • Gas tecnici e loro miscele Compressed air • Technical gases and their mixtures
PRESSIONE DI ESERCIZIO MASSIMA MAX. INLET PRESSURE	Con scarico automatico o semi automatico <b>16 bar</b> • Con scarico manuale o senza scarico (tappo) <b>30 bar</b> With automatic or semi-automatic drain • With manual drain or without drain (cap)
ATTACCHI A PROCESSO IN/OUT CONNECTION	<b>FR38-FR12 MD:</b> 3/8"-F • 1/2"-F (GAS/NPT) <b>FR15-FR20 MD:</b> 1 1/2"-F • 2"-F (GAS/NPT)
TEMPERATURA DI ESERCIZIO WORKING TEMPERATURE	-10°+50°C (+14° +122 °F) standard altri range a richiesta / other temperature ranges on request
GRADO DI FILTRAZIONE FILTRATION RATE	5µm • 50 µm (bronzo sinterizzato / sintered bronze)
KV (CEI EN 60534-2) CV (CEI EN 60534-2)	2,99 m3/h (FR38-FR12 MD) • 24,9 m3/h (FR15-FR20MD) 3,4 US gal/min (FR38-FR12 MD) • 28,8 US gal/min (FR15-FR20MD)
PRESSIONI REGOLABILI OUTLET PRESSURE RANGE	0,2 ÷ 1,5 • 0,3 ÷ 3 • 0,8 ÷ 8 • 1,5 ÷ 15 bar
PESO WEIGHT	~0,9 kg (FR38-FR12 MD) • ~11,8 kg (FR15-FR20MD) ~1,9 lb (FR38-FR12 MD) • ~26,2 lb (FR15-FR20MD)
CLASSE DI TENUTA OTTURATORE PLUG LEAKAGE CLASS	Grado "A" (UNI EN 12266-1) "A" class (UNI EN 12266-1)
CONNESSIONE MANOMETRO PRESSURE GAUGE CONNECTION	1/4"-F (GAS / NPT)
CERTIFICAZIONI CERTIFICATIONS	PED 2014/68/UE • ATEX 2014/34/UE • EAC TR CU 010 • EAC Ex TR CU 012 • EAC TR CU 032* *solo per/Only available on FR15-FR20 MD
MATERIALE CORPO E PARTI INTERNE INTERNALS AND BODY MATERIAL	Alluminio / plastica / ottone Aluminum / plastic / brass
MATERIALE GUARNIZIONI SEALS MATERIAL	NBR • EPDM • FPM
ACCESSORI ACCESSORIES	Manometro • Staffa Pressure gauge • Wall mounting bracket
KIT RICAMBIO SPARE PARTS KIT	O-ring, otturatore assemblato, cartuccia filtrante, membrana assemblata (se prevista) O-rings, assembled plug, filter cartridge, assembled diaphragm (if applicable)