

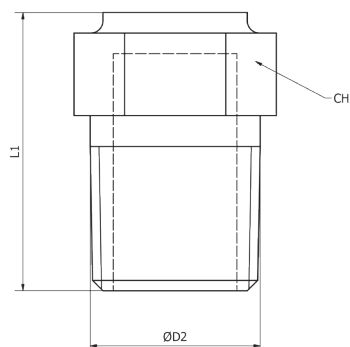





AP 20K





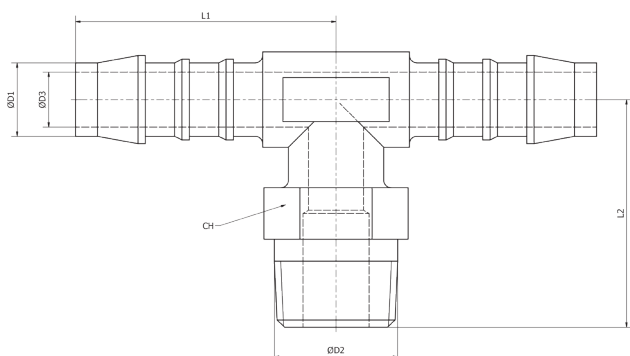

-  **Tappo maschio conico poliammide**
-  Male plug taper polyamide
-  Stopfen konisches Gewinde Polyamid
-  Bouchon à 6 pans mâle, cónique, polyamide
-  Tapón macho cónico, poliamida

CODICE/CODE	ØD2	L1	CH	PEZZI/PIECES
AP20K0018	R1/8	12,5	10	10
AP20K0014	R1/4	17,5	14	10
AP20K0038	R3/8	27	17	10
AP20K0012	R1/2	27,5	22	10

AP 25K





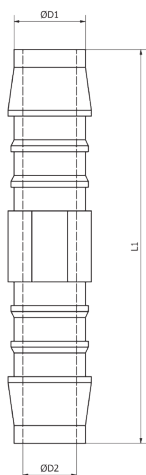

-  **Portagomma "T" maschio centrale conico poliammide**
-  Central "T" male taper hose adapter polyamide
-  T Verbinder konisches Gewinde Polyamid
-  Tè égal mâle conique, polyamide
-  Espiga a T macho central, cónica, poliamida

CODICE/CODE	ØD1	ØD2	ØD3	L1	L2	CH	PEZZI/PIECES
AP25K1804	4	R1/8	2,5	21	18	10	10
AP25K1404	4	R1/4	2,5	21	23	14	10
AP25K1806	6	R1/8	4	28,5	21	10	10
AP25K1406	6	R1/4	4	28,5	26	14	10
AP25K1408	8	R1/4	5,6	33	27,5	14	10
AP25K3810	10	R3/8	7	35,5	30	17	10

AP 30



-  **Portagomma intermedio diritto POM**
-  Straight intermediate hose male adapter POM
-  Gerader Verbinder POM
-  Douille annelée droit, POM
-  Espiga intermedia recta, POM

CODICE/CODE	ØD1	ØD2	L1	PEZZI/PIECES
AP300003	3	2,5	25	10
AP300004	4	2,7	35	10
AP300005	5	3	45	10
AP300006	6	4	49	10
AP300008	8	5,6	56	10
AP300010	10	7	63	10
AP300012	12	8,6	66,5	10
AP300013	13	8,6	73	10
AP300014	14	10	79	10
AP300016	16	12	75	10
AP300019	19	15	76	10
AP300025	25	21	95	10