

**Material:** Brass Nickel Plated  
**Working Temperature:** -20 ÷ 70 C°  
**Working Temperature:** F°  
**Working Pressure (max):** 60 bar  
**Working Pressure (max):** psi  
**Vacuum:** kPa  
**Vacuum:** Hg  
**Conformity:** RoHS

**Conformity:**  
**Conformity:**  
**Conformity:**  
**Conformity:**  
**Application** Pneumatic, hydraulic and oleodynamic circuits

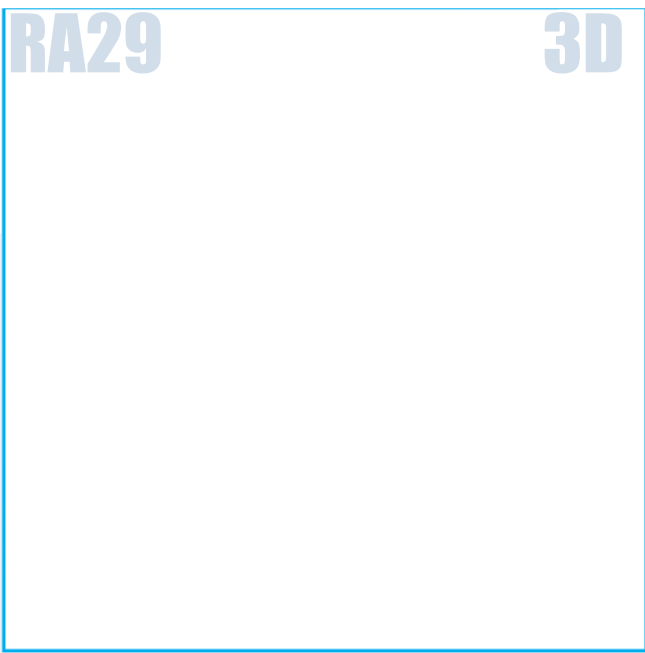
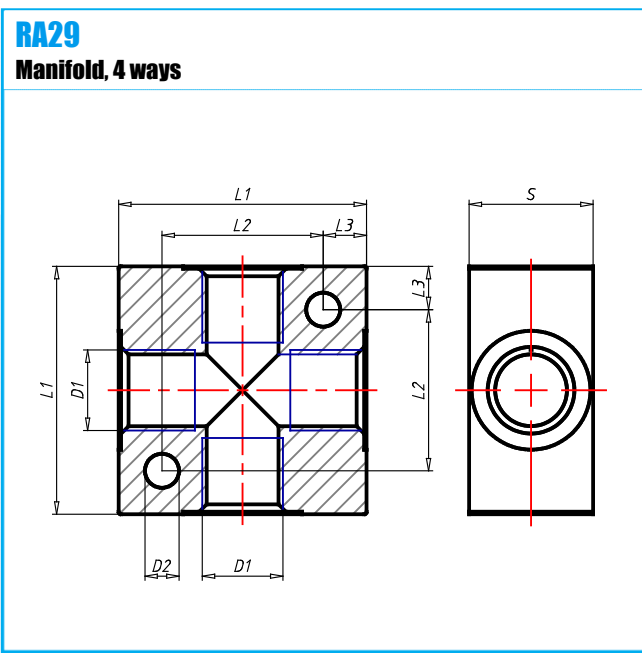

| CODE     | TYPE       | D1     | D2  | L1 | L2 | L3 | S  | G   |
|----------|------------|--------|-----|----|----|----|----|-----|
| 05190000 | RA29 00 M5 | M5x0,8 | 3.2 | 20 | 14 | 3  | 10 | 9   |
| 05190001 | RA29 00 18 | G1/8   | 4.5 | 25 | 17 | 4  | 16 | 18  |
| 05190002 | RA29 00 14 | G1/4   | 5.5 | 40 | 26 | 7  | 20 | 64  |
| 05190003 | RA29 00 38 | G3/8   | 5.5 | 50 | 34 | 8  | 25 | 125 |
| 05190004 | RA29 00 12 | G1/2   | 5.5 | 50 | 34 | 8  | 30 | 138 |