

1	2
<p>Corpo del raccordo Fitting Body Corps du raccord Verschraubungskörper</p> <p>Ottone UNI EN 12164 CW614N - UNI EN 12165 CW617N Nichelato Brass UNI EN 12164 CW614N - UNI EN 12165 CW617N Nickel Plated Laiton UNI EN 12164 CW614N - UNI EN 12165 CW617N Nickelé Messing UNI EN 12164 CW614N - UNI EN 12165 CW617N vernickelt</p>	<p>Guarnizioni Seals Joint d'étanchéité Dichtung</p> <p>NBR NBR NBR NBR</p>

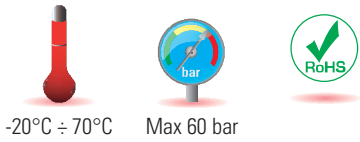

-20°C ÷ 70°C

Max 60 bar

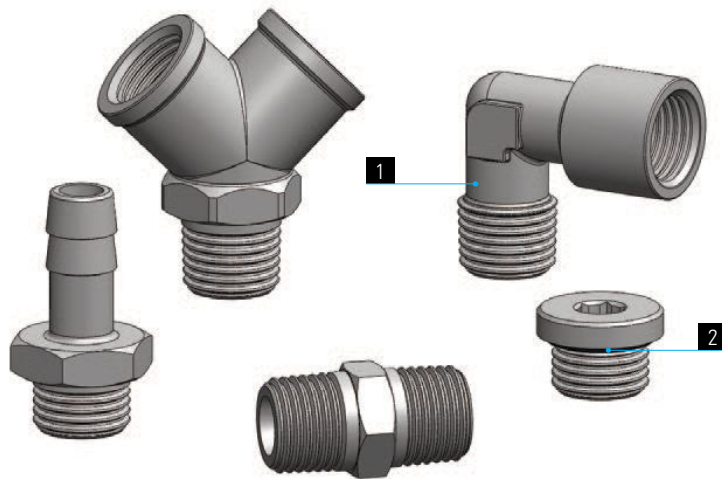

	M5x0,8	G1/8	G1/4	G3/8	G1/2	G3/4	G1"	R1/8	R1/4	R3/8	R1/2	R3/4	R1"
	●	●	●	●	●	●	●	●	●	●	●	●	●

Campi di applicazione:
Impianti pneumatici, idraulici ed oleodinamici.

Application fields:
Pneumatic, hydraulic and oleodynamic circuits.

Domaines d'application:
Circuits pneumatiques, hydrauliques et oléodynamiques.

Anwendungsbereiche:
Hydraulische, öldynamische und pneumatische Anlagen.

RA 35

Gomito M-M

Male-Male Elbow

Equerre Mâle

Einschraub-Winkelstück

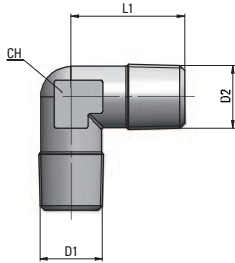

Tipo	D1	D2	L1	CH	g	ΔΔ
35 18 18	R1/8	R1/8	18,5	10		13
35 14 14	R1/4	R1/4	23,5	13		27
35 38 38	R3/8	R3/8	26	17		41
35 12 12	R1/2	R1/2	31	21		71
35 34 34	R3/4	R3/4	33	25		100
35 1" 1"	R1"	R1"	39	30		174

RA 36

T M-M-M

Male Tee

Té Mâle

Einschraub-T-Stück

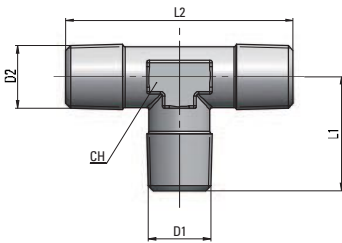

Tipo	D1	D2	L1	L2	CH	g	ΔΔ
36 18 18	R1/8	R1/8	18,5	37	10		15
36 14 14	R1/4	R1/4	23,5	47	13		39
36 38 38	R3/8	R3/8	26	52	17		56
36 12 12	R1/2	R1/2	31	62	21		93
36 34 34	R3/4	R3/4	33	66,4	25		134
36 1" 1"	R1"	R1"	39	79	30		236

RA 38

Riduzione a Gomito M-M

Elbow reduction Male-Male

Réduction équerre, Mâle-Mâle

Einschraub-Reduzierstück

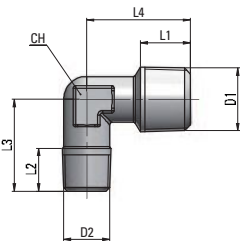

Tipo	D1	D2	L1	L2	L3	L4	CH	g	ΔΔ
38 18 14	R1/4	R1/8	11	8	19	21,5	10		17

RA 39

Prolunga M-F

Extention Male-Female

Prolongation Mâle-Femelle

Verlängerung M-F

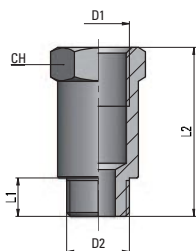

Tipo	D1	D2	L1	L2	CH	g	ΔΔ
39 18 22	G1/8	G1/8	6	22	14		15
39 18 42	G1/8	G1/8	6	42	14		30
39 14 35	G1/4	G1/4	8	35	17		32
39 14 51	G1/4	G1/4	8	51	17		46