

MX 26

Giunzione Intermedia

Union

Union simple égale

Gerade Verbindung

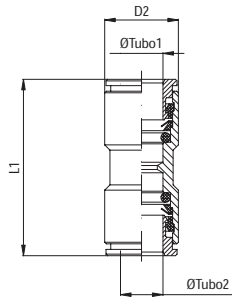

Tipo	Øe Tubo1	Øe Tubo2	D2	L1	g Δ
26 04 00	4	4	9	27	8
26 06 00	6	6	12	32,5	16
26 08 00	8	8	14	33	19,5
26 10 00	10	10	16	37,5	25
26 12 00	12	12	18	39,5	30

MX 27

Giunzione Intermedia passaparte

Straight bulkhead

Union traversée de cloison

Gerade Schottverschraubung

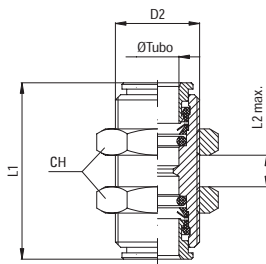

Tipo	Øe Tubo	D2	L1	L2 MAX	CH	g Δ
27 04 04	4	M12x1	27	11	15	20
27 06 06	6	M14x1	32,5	16	17	31,5
27 08 08	8	M16x1	33	17	19	37,5
27 10 10	10	M18x1	37,5	19	21	48
27 12 12	12	M20x1	39,5	20	24	62

MX 28

Gomito Intermedio

Union Elbow

Raccord à Coude

Winkelverschraubung

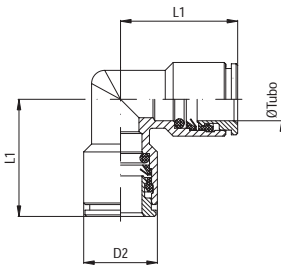

Tipo	Øe Tubo	D2	L1	g Δ
28 04 04	4	9	17	11,5
28 06 06	6	12	20	18
28 08 08	8	14	21	24
28 10 10	10	16	25	42
28 12 12	12	18	27	49

MX 29

T Intermedio

Union Tee

Raccord à Té

T-Verschraubung

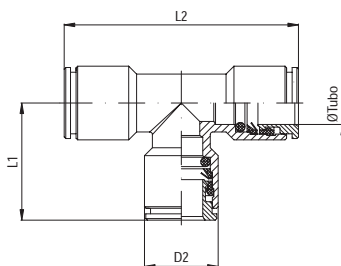

Tipo	Øe Tubo	D2	L1	L2	g Δ
29 04 04	4	9	17	34	14
29 06 06	6	12	20	40	29,5
29 08 08	8	14	21	42	32
29 10 10	10	16	25	50	55
29 12 12	12	18	27	54	59