

PN 11

Taper Straight, male

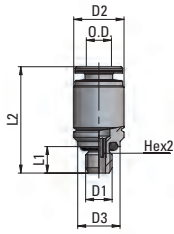

Part Number	Tube OD	D1 UNF	D2	D3	L1	L2	HEX2	oz Δ
11 1/8 10-32	1/8	10-32	.276	.315	.197	.657	3/32	.088
11 5/32 10-32	5/32	10-32	.374	.315	.197	.787	3/32	.159
11 1/4 10-32	1/4	10-32	.472	.315	.197	.925	3/32	.300

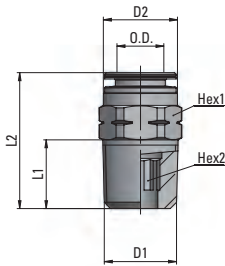

Part Number	Tube OD	D1 NPTF	D2	L1	L2	HEX1	HEX2	oz Δ
11 1/8 1/8	1/8	1/8	.276	.335	.728	7/16	3/32	.335
11 5/32 1/8	5/32	1/8	.374	.335	.728	7/16	1/8	.318
11 5/32 1/4	5/32	1/4	.374	.512	.945	9/16	1/8	.706
11 1/4 1/8	1/4	1/8	.472	.335	.866	1/2	5/32	.371
11 1/4 1/4	1/4	1/4	.472	.512	.965	9/16	5/32	.653
11 1/4 3/8	1/4	3/8	.472	.512	1.004	11/16	5/32	-
11 5/16 1/8	5/16	1/8	.551	.335	1.043	9/16	3/16	.529
11 5/16 1/4	5/16	1/4	.551	.512	1.004	9/16	1/4	.565
11 5/16 3/8	5/16	3/8	.551	.512	.984	11/16	1/4	.988
11 3/8 1/8	3/8	1/8	.630	.335	1.122	11/16	3/16	.794
11 3/8 1/4	3/8	1/4	.630	.512	1.260	11/16	1/4	.953
11 3/8 3/8	3/8	3/8	.630	.512	1.004	11/16	5/16	.900
11 3/8 1/2	3/8	1/2	.630	.669	1.201	7/8	5/16	1.976
11 1/2 1/4	1/2	1/4	.787	.512	1.358	13/16	5/16	1.253
11 1/2 3/8	1/2	3/8	.787	.512	1.161	13/16	13/32	.970
11 1/2 1/2	1/2	1/2	.787	.669	1.201	7/8	13/32	1.606

PN 13

Female Straight

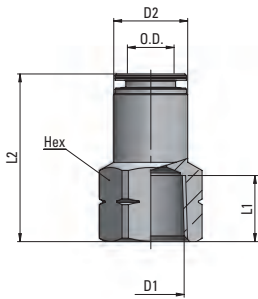

Part Number	Tube OD	D1 NPTF	D2	L1	L2	HEX	oz Δ
13 5/32 1/8	5/32	1/8	.374	.335	.984	1/2	.406
13 1/4 1/8	1/4	1/8	.472	.335	1.063	1/2	.494
13 1/4 1/4	1/4	1/4	.472	.492	1.240	11/16	.935
13 5/16 1/8	5/16	1/8	.551	.335	1.063	9/16	.706
13 5/16 1/4	5/16	1/4	.551	.492	1.240	11/16	1.006
13 3/8 1/4	3/8	1/4	.630	.492	1.339	11/16	1.147
13 3/8 3/8	3/8	3/8	.630	.492	1.339	13/16	1.323

PN 14

Taper Elbow Fitting, male

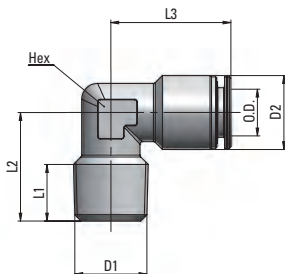

Part Number	Tube OD	D1 NPTF	D2	L1	L2	L3	HEX (mm)	oz Δ
14 5/32 1/8	5/32	1/8	.374	.335	.630	.689	10	.318
14 1/4 1/8	1/4	1/8	.472	.335	.630	.807	10	.459
14 1/4 1/4	1/4	1/4	.472	.433	.787	.807	10	.600
14 5/16 1/8	5/16	1/8	.551	.335	.748	.886	12	.723
14 5/16 1/4	5/16	1/4	.551	.433	.807	.886	12	.794
14 3/8 1/4	3/8	1/4	.630	.472	.886	.984	14	1.041
14 3/8 3/8	3/8	3/8	.630	.433	.886	.984	14	1.182