

PN 15

Gomito maschio conico girevole

Taper Swivelling Elbow Fitting, male

Raccord à coude tournant, mâle conique

Schwenkbare Winkelverschraubung, kegelig

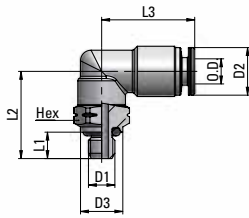

Tipo	Tubo OD	D1 UNF	D2	D3	L1	L2	L3	HEX	g ΔΔ
15 1/8 10-32	1/8"	10-32	7	8	5	16,5	13,7	3/8"	8,00
15 5/32 10-32	5/32"	10-32	9,5	8	5	16,5	17,5	3/8"	10,00

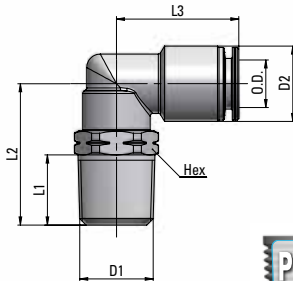

Tipo	Tubo OD	D1 NPTF	D2	L1	L2	L3	HEX	g ΔΔ
15 1/8 1/8	1/8"	1/8	7	8,5	18,5	13,7	7/16"	10,50
15 5/32 1/8	5/32"	1/8	9,5	8,5	18,5	17,5	7/16"	12,50
15 5/32 1/4	5/32"	1/4	9,5	13	26	19	9/16"	22,50
15 1/4 1/8	1/4"	1/8	12	8,5	21	22	1/2"	19,50
15 1/4 1/4	1/4"	1/4	12	13	26	22	9/16"	24,50
15 1/4 3/8	1/4"	3/8	12	13	26,5	22	11/16	31,00
15 5/16 1/8	5/16"	1/8	14	8,5	21	22,5	1/2"	23,00
15 5/16 1/4	5/16"	1/4	14	13	24	22,5	9/16"	27,50
15 5/16 3/8	5/16"	3/8	14	13	28,5	23	11/16"	40,00
15 3/8 1/8	3/8"	1/8	16	8,5	24	26	11/16"	39,00
15 3/8 1/4	3/8"	1/4	16	13	28,5	26	11/16"	42,50
15 3/8 3/8	3/8"	3/8	16	13	28,5	26	11/16"	43,50
15 3/8 1/2	3/8"	1/2	16	17	34	26	7/8"	62,00
15 1/2 1/4	1/2"	1/4	20	13	32	28,5	13/16"	67,50
15 1/2 3/8	1/2"	3/8	20	13	32	28,5	13/16"	64,00
15 1/2 1/2	1/2"	1/2	20	17	36,5	28,5	7/8"	76,50

PN 17

Gomito femmina girevole

Swivelling Elbow fitting, female

Raccord à coude tournant femelle

Drehbare Winkel-Aufschraubverschraubung

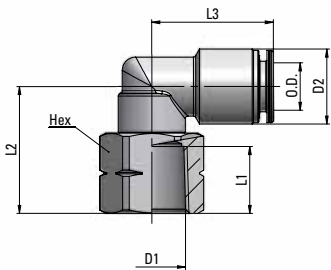

Tipo	Tubo OD	D1 NPTF	D2	L1	L2	L3	HEX	g ΔΔ
17 5/32 1/8	5/32"	1/8	9,5	8,5	19,5	19	9/16"	21,00
17 1/4 1/8	1/4"	1/8	12	8,5	19,5	22	9/16"	22,50
17 1/4 1/4	1/4"	1/4	12	12,5	23,5	22	11/16"	32,00
17 5/16 1/8	5/16"	1/8	14	8,5	19,5	22,5	9/16"	26,50
17 5/16 1/4	5/16"	1/4	14	12,5	23,5	22,5	11/16"	36,50
17 3/8 1/4	3/8"	1/4	16	12,5	25,5	26	11/16"	44,50
17 3/8 3/8	3/8"	3/8	16	12,5	25,5	26	13/16"	48,50

PN 18

Girevole con anello singolo

Swivelling fitting with banjo ring

Raccord tournant avec banjo

Schwenkverschraubung mit Ringstück

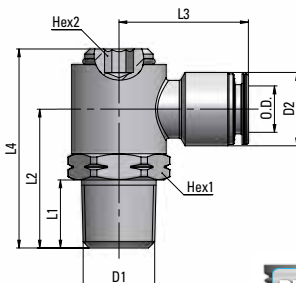

Tipo	Tubo OD	D1 NPTF	D2	L1	L2	L3	L4	HEX1	HEX2	g ΔΔ
18 5/32 1/8	5/32"	1/8	9,5	8,5	20,5	20,5	31	9/16"	1/8"	28,50
18 1/4 1/8	1/4"	1/8	12	8,5	20,5	22,5	31	9/16"	1/8"	30,00
18 1/4 1/4	1/4"	1/4	12	13	26,5	24	38	11/16"	3/16"	48,50
18 5/16 1/8	5/16"	1/8	14	8,5	20,5	23	31	9/16"	1/8"	30,50
18 5/16 1/4	5/16"	1/4	14	13	26,5	24,5	38	11/16"	3/16"	49,50
18 5/16 3/8	5/16"	3/8	14	13	29	26,5	42	13/16"	1/4"	64,27
18 3/8 1/4	3/8"	1/4	16	13	26,5	26,5	38	11/16"	3/16"	52,00
18 3/8 3/8	3/8"	3/8	16	13	29	29	42	13/16"	1/4"	84,00