

# UNP80

UNIVERSAL Power clamps  
conforming to **NAAMS** Standard



|   |   |   |   |   |   |   |   |   |   |
|---|---|---|---|---|---|---|---|---|---|
| U | N | P | 8 | 0 | N | N | E | N | H |
| 1 | 2 | 3 | 4 | 5 | 6 | 7 |   |   |   |



|                 |                  |               |
|-----------------|------------------|---------------|
| <b>1 Series</b> | <b>2 Version</b> | <b>3 Size</b> |
|-----------------|------------------|---------------|

**UN** = UNIVERSAL Power clamps conforming to **NAAMS** Standard fully adjustable opening angle: **0° to 135° Max**

**P** = Pneumatic

**80** = Ø 80 mm

|                       |                       |                 |
|-----------------------|-----------------------|-----------------|
| <b>4 Arm position</b> | <b>5 Square shaft</b> | <b>6 Sensor</b> |
|-----------------------|-----------------------|-----------------|

**N** = No arm

**R** = Right side only

**N** = No sensor (with protection plate)

**L** = Left side only

**E** = Electronic sensor with M12 swivel connector

**N** = Both sides

|                      |
|----------------------|
| <b>7 Port thread</b> |
|----------------------|

**G** = Gas

**NH** = NPT

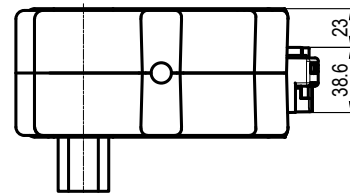
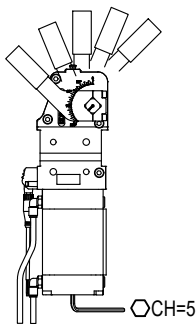
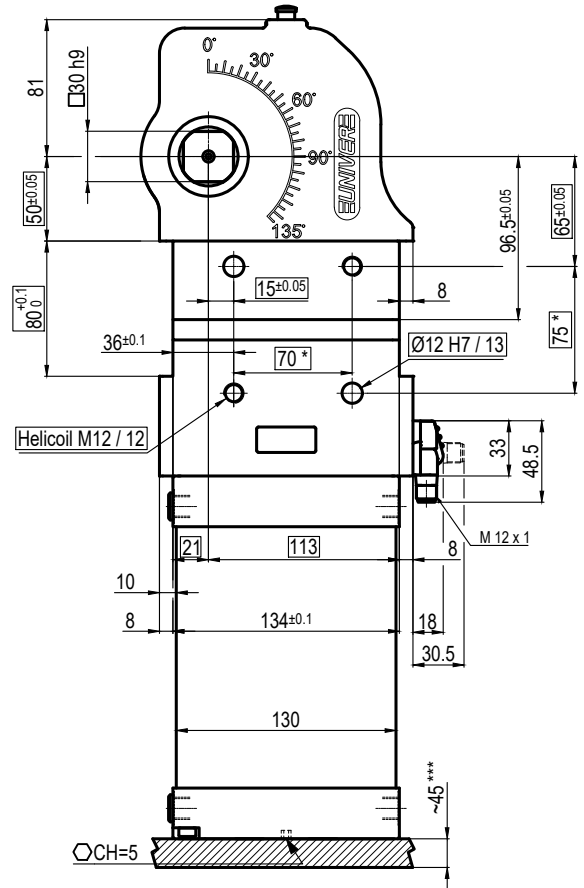
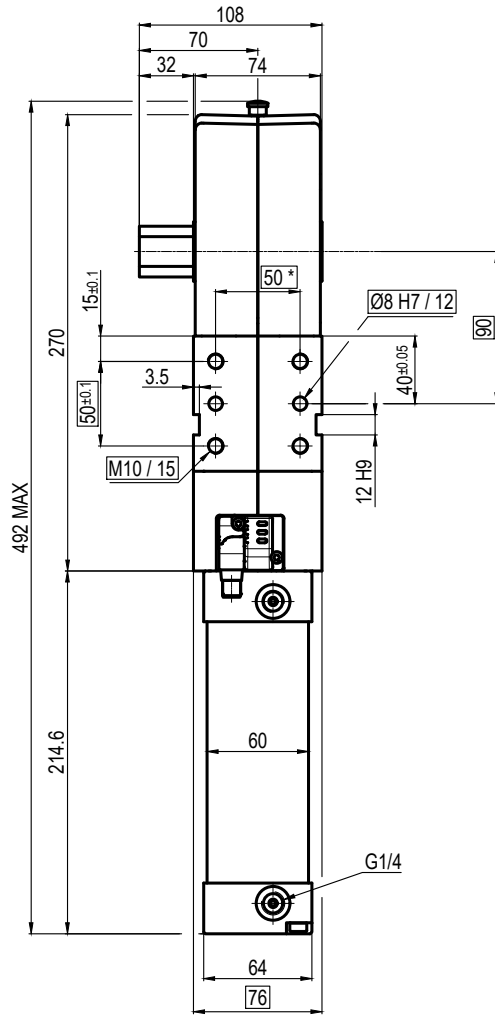

| Bore Ø | Holding moment | Clamping moment (0.5 MPa) | Weight (Clamping arm not included) |
|--------|----------------|---------------------------|------------------------------------|
| 80 mm  | 4000 Nm        | 1100 Nm                   | 10.4 Kg                            |

Min./Max. operating pressure: **0,4 / 0,6 MPa**

Operating temperature: **5° ÷ 45° C**

Opening angle: **adjustable**

Without arm

Electronic sensor with M12 swivel connector that can be orientated at 0° or 90°

Supply voltage: 10+30 Vdc

IP code: **IP 65**

Pneumatic ports on both sides

\* : TOLERANCE BETWEEN DOWEL HOLES ± 0.02, BETWEEN SCREW HOLES ± 0.1

\*\* : THE MEASURES REFER TO **NAAMS** STANDARD

\*\*\* : AREA TO ACCESS ANGLE ADJUSTMENT.

Subject to technical modifications without notice

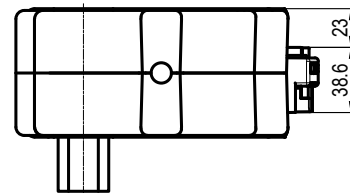
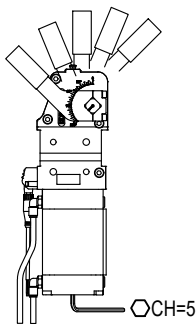
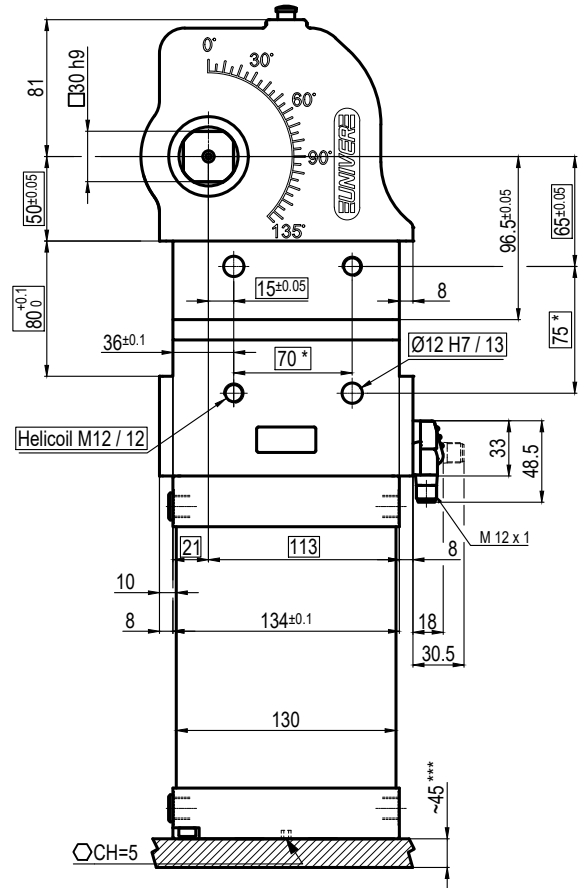
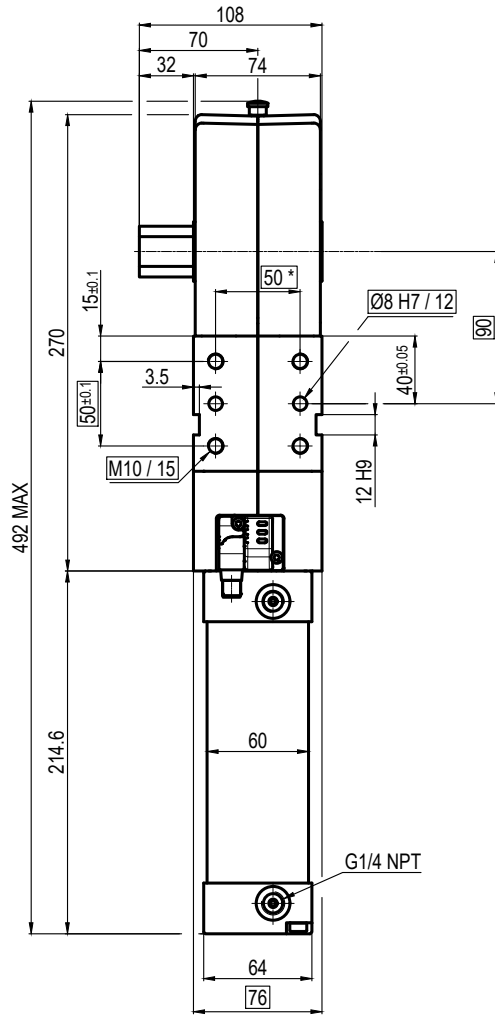

| Bore Ø | Holding moment | Clamping moment (0.5 MPa) | Weight (Clamping arm not included) |
|--------|----------------|---------------------------|------------------------------------|
| 80 mm  | 4000 Nm        | 1100 Nm                   | 10.4 Kg                            |

Min./Max. operating pressure: **0,4 / 0,6 MPa**

Operating temperature: **5° ÷ 45° C**

Opening angle: **adjustable**

Without arm

Electronic sensor with M12 swivel connector that can be orientated at 0° or 90°

Supply voltage: 10÷30 Vdc

IP code: **IP 65**

Pneumatic ports on both sides

\* : TOLERANCE BETWEEN DOWEL HOLES ± 0.02, BETWEEN SCREW HOLES ± 0.1

\*\* : THE MEASURES REFER TO **NAAMS** STANDARD

\*\*\* : AREA TO ACCESS ANGLE ADJUSTMENT.

Subject to technical modifications without notice

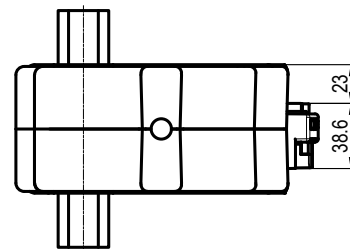
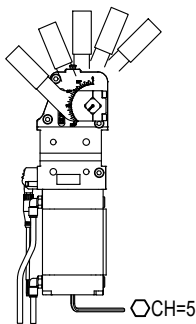
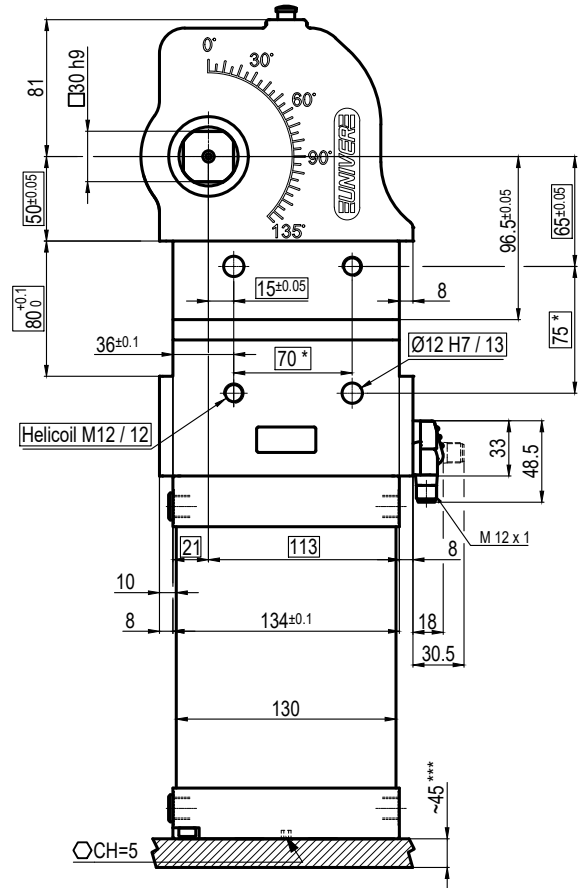
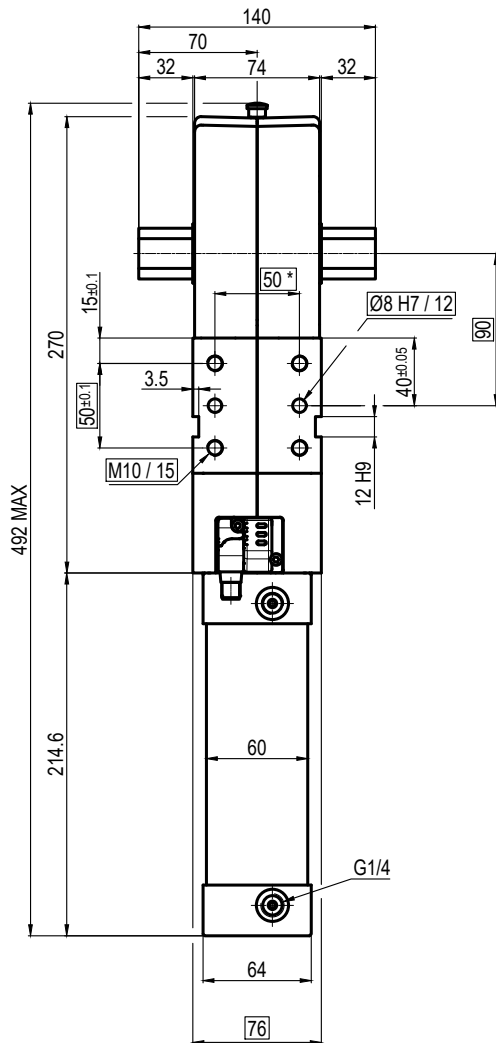

| Bore Ø | Holding moment | Clamping moment (0.5 MPa) | Weight (Clamping arm not included) |
|--------|----------------|---------------------------|------------------------------------|
| 80 mm  | 4000 Nm        | 1100 Nm                   | 10.4 Kg                            |

Min./Max. operating pressure: **0,4 / 0,6 MPa**

Operating temperature: **5° ÷ 45° C**

Opening angle: **adjustable**

Without arm

Electronic sensor with M12 swivel connector that can be orientated at 0° or 90°

Supply voltage: 10+30 Vdc

IP code: **IP 65**

Pneumatic ports on both sides

\* : TOLERANCE BETWEEN DOWEL HOLES ± 0.02, BETWEEN SCREW HOLES ± 0.1

\*\* : THE MEASURES REFER TO **NAAMS** STANDARD

\*\*\* : AREA TO ACCESS ANGLE ADJUSTMENT.

Subject to technical modifications without notice

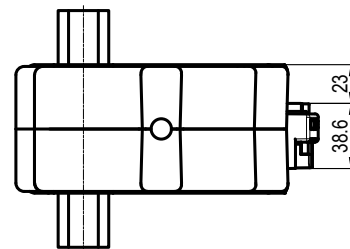
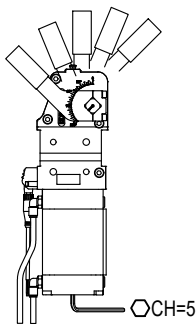
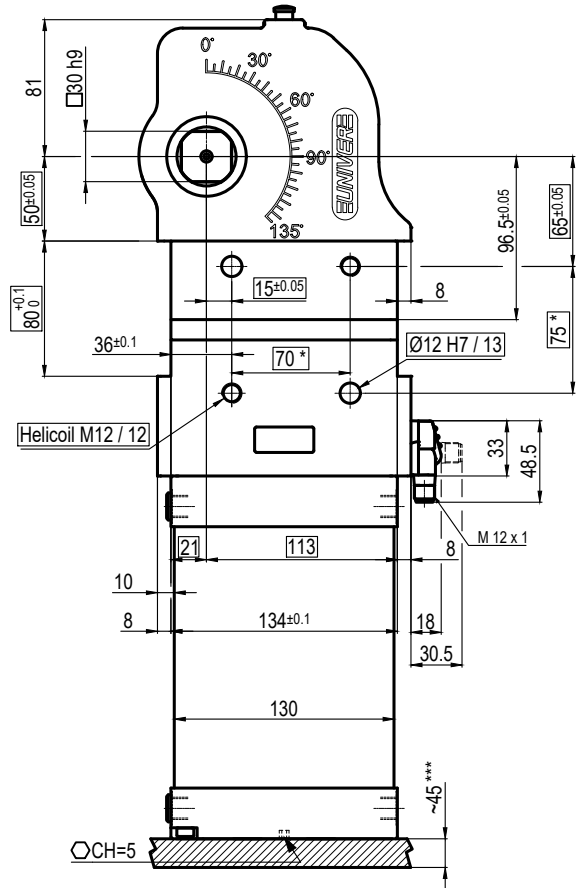
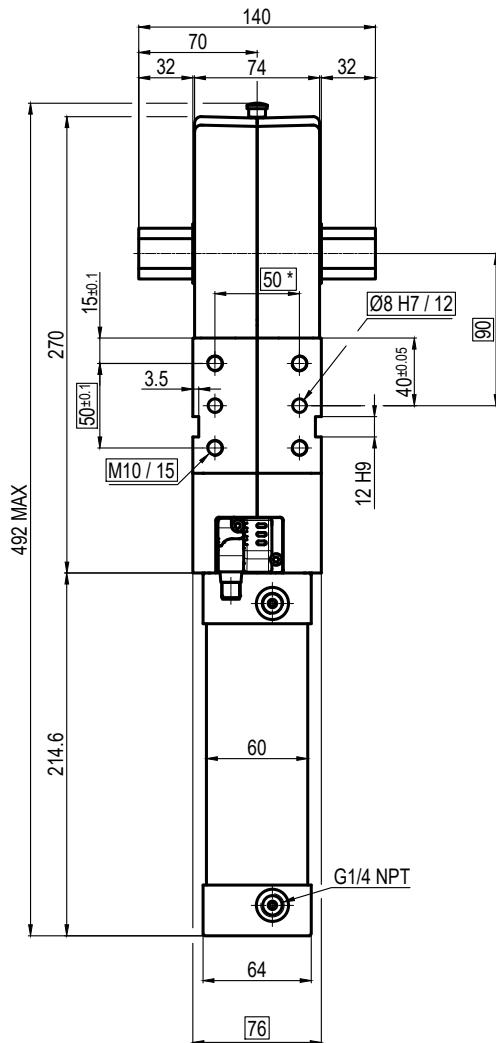

| Bore Ø | Holding moment | Clamping moment (0.5 MPa) | Weight (Clamping arm not included) |
|--------|----------------|---------------------------|------------------------------------|
| 80 mm  | 4000 Nm        | 1100 Nm                   | 10.4 Kg                            |

Min./Max. operating pressure: **0,4 / 0,6 MPa**

Operating temperature: **5° ÷ 45° C**

Opening angle: **adjustable**

Without arm

Electronic sensor with M12 swivel connector that can be orientated at 0° or 90°

Supply voltage: 10+30 Vdc

IP code: **IP 65**

Pneumatic ports on both sides

\* : TOLERANCE BETWEEN DOWEL HOLES ± 0.02, BETWEEN SCREW HOLES ± 0.1

\*\* : THE MEASURES REFER TO **NAAMS** STANDARD

\*\*\* : AREA TO ACCESS ANGLE ADJUSTMENT.

Subject to technical modifications without notice

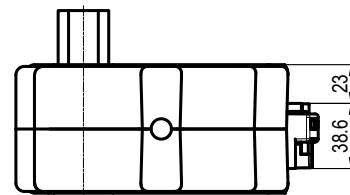
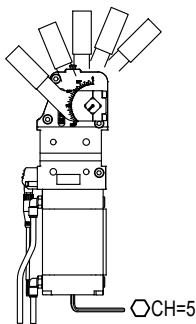
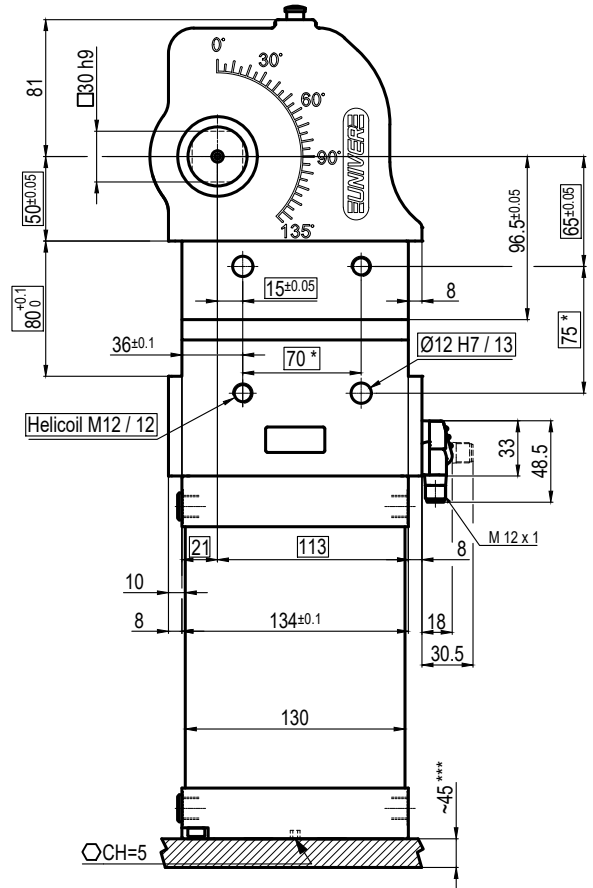
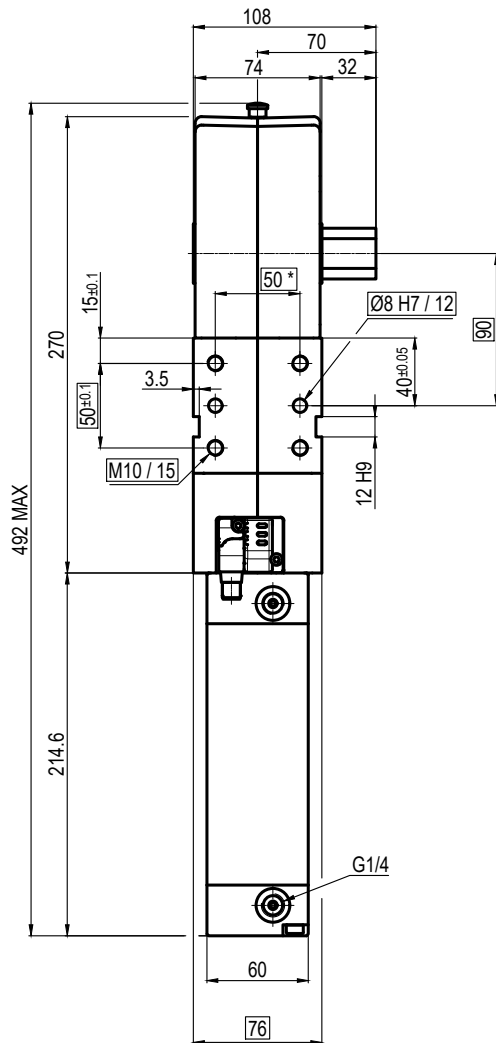

| Bore Ø | Holding moment | Clamping moment (0.5 MPa) | Weight (Clamping arm not included) |
|--------|----------------|---------------------------|------------------------------------|
| 80 mm  | 4000 Nm        | 1100 Nm                   | 10.4 Kg                            |

Min./Max. operating pressure: **0,4 / 0,6 MPa**

Operating temperature: **5° ÷ 45° C**

Opening angle: **adjustable**

Without arm

Electronic sensor with M12 swivel connector that can be orientated at 0° or 90°

Supply voltage: 10+30 Vdc

IP code: **IP 65**

Pneumatic ports on both sides

\* : TOLERANCE BETWEEN DOWEL HOLES ± 0.02, BETWEEN SCREW HOLES ± 0.1

\*\* : THE MEASURES REFER TO **NAAMS** STANDARD

\*\*\* : AREA TO ACCESS ANGLE ADJUSTMENT.

Subject to technical modifications without notice

